



White Acrylic (WHA) diffuser



CH end caps, WHA diffuser

5020 LED

The 5020 LED is available in three sizes with a variety of other options to choose from. This versatile light bar is commonly used over the mirror as a vanity luminaire, as well as a 4' stairwell solution. High/low bi-level dimming and integral battery backup options available. Wall or ceiling mount.

STRIP

STANDARD SPECIFICATIONS

HOUSING

Cold rolled steel, die-formed and assembled with hardware and welds, and can be mounted horizontally or vertically. The end caps are die-formed and secure the diffuser to the housing with nuts.

DIFFUSER

Translucent UV stabilized white acrylic. The extruded diffuser slips into a designed track to ensure it stays in position, and the material can withstand minor impact without breaking.

LED PERFORMANCE - 3500K STANDARD

120-277V - 3500K, 90+ CRI - L80 rating - 60,000 hrs - L70 rating (projected) - 100,000 hrs
Amperage rated @ 110V input
Operating ambient temperature: -20°C / -4°F - 40°C / 104°F

Standard 3500K delivered lumens noted (White Acrylic diffuser).
Consult Brownlee.com for performance of all CCTs.

H16 - 16W nominal, .14 A input - 1366 lm. Dimmable (0-10V).
H21 - 21W nominal, .18 A input - 1576 lm. Dimmable (0-10V).
H25 - 25W nominal, .20 A input - 2051 lm. Dimmable (0-10V).
H31 - 31W nominal, .27 A input - 2564 lm. Dimmable (0-10V).
H32 - 32W nominal, .26 A input - 2436 lm. Dimmable (0-10V).
H41 - 41W nominal, .35 A input - 3015 lm. Dimmable (0-10V).

MOUNTING

Fixture uses wall anchors (by others) appropriate for the mounting surface. Wall or ceiling.

FINISH

The 5020 series housing is finished in white, and the end caps are available in either white or polished chrome. The finish for this series is suitable for indoor applications only. Installation outdoors voids the Brownlee Limited Warranty.

WARRANTY

5 year limited warranty on this LED product. Consult factory for details.

PROJECT:
MODEL #:
FIXTURE TYPE:



CH end caps, WHA diffuser

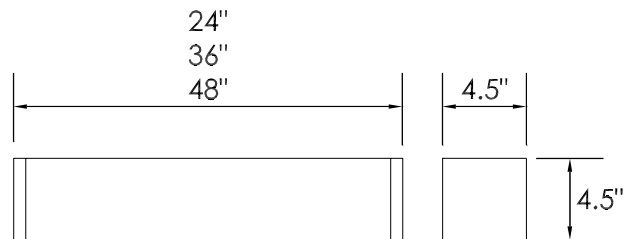

DAMP

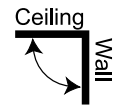

ORDERING INFORMATION

5020 - Model - 2. - 3. - 4. - 5. - 6. - 7. (if required)

2. SIZE	3. END CAPS	4. WATTAGE	5. DIFFUSER	6. COLOR TEMPERATURE
24 L: 24"	CH Chrome	24 SIZE	STANDARD	35K 3500K standard color temperature
36 L: 36"	WH White	H16 16W H Series LED	WHA White Acrylic	30K 3000K color temperature
48 L: 48"		H21 21W H Series LED		40K 4000K color temperature
		36 SIZE		
		H25 25W H Series LED		
		H31 31W H Series LED		
		48 SIZE		
		H32 32W H Series LED		
		H41 41W H Series LED		
				7. AVAILABLE OPTIONS
				BAC ¹ Buy American Compliant
				BB1 ^{2*} Integral Battery Backup (8W) (H25 & H32 only) <i>Battery must be connected to continuous power supply within 7 Mo. of shipping. See Warranty Note 3.</i>
				BLD ^{3**} Bi-Level Dimming
				DTR ⁴ Triac (Line Voltage) Dimming (120V)
				ES ⁶ ENERGY STAR® (Not available in 90 CRI) (H16, H25, H32 only)
				FCL ⁷ French Canadian Labels
				OCC ⁸ Occupancy Sensor
				PCH ¹⁰ Pull Chain: On, Off (120V)
				T24 ⁹ Title 24 JA8 Compliant (H16, H25 & H32 only)

Universal Footnotes (only applies if option is listed on spec sheet): (0) 90R - 90 CRI output-loss multiplier: 0.85 (estimate). Cannot be combined with ES. (1) BAC - cannot be combined with FCL. (2) BB1/BBS/BBC - cannot be combined with ECW or EXT. (3) BLD - includes integral microwave motion sensor (do not combine with OCC option). Cannot be combined with DTR. (4) DTR - cannot be combined with BLD. (5) ECW - cannot be combined with BBI, BBC, or DTR. (6) ES - cannot be combined with 90R or T24. (7) FCL - cannot be combined with BAC. (8) OCC - integral microwave motion sensor (ON/OFF). (9) T24 - includes JA8 labeling and 90 CRI LEDs (do not combine with 90R option). Cannot be combined with ES. (10) PCH/PC4 - cannot be combined with BLD or OCC. **Add'l Notes:** *BB1/BBC - BBI minimum operating temp: 10C/50F unless otherwise stated. BBC minimum operating temp: -20C/-4F. **BLD - integral microwave motion sensor with step-dim control. 1: Motion is detected, illuminate to 100%. 2: Motion no longer detected, dim to set level. 3: Remain in continuous dimmed state or turn off after set period. Configurable via onboard dip switches.

Specifications and dimensions subject to change without notice.

Consult your Brownlee Lighting representative for availability and ordering information.



REVISED
2023.11.02