



1440 LED

The 1440's tulip shape and form factor makes for a unique wall luminaire that is ADA compliant and perfect for any upscale commercial or residential application. The contemporary one-piece diffuser is constructed of thick, opal-white glass which is formed with a closed top. Architectural cast aluminum trim is standard in Brushed Nickel with a variety of optional finishes to choose from. Other models in this series include the 1442, 1445 and 1447.

FINISHES



CURVY

STANDARD SPECIFICATIONS

TRIM

Tapered die-cast aluminum trim piece attaches directly to the cold rolled steel housing. Trim contains no exposed hardware.

DIFFUSER

Diffuser is constructed of 0.20" thick opal-white glass which is formed with a closed top. Diffuser seats securely into the trim and is held into position with a screw from the top.

HOUSING

Formed cold rolled steel design, finished in a powder coat high reflectance white paint.

LED PERFORMANCE - 3500K STANDARD

120-277V - 3500K, 82 CRI - L80 rating - 60,000 hrs - L70 rating (projected) - 100,000 hrs
Amperage rated @ 110V input
Operating ambient temperature: -20°C / -4°F - 40°C / 104°F
Refer to Wattage section for lumen output. Consult Brownlee.com for performance of all CCTs.

MOUNTING

Directly to j-box (by others). Mounting hardware included.

FINISH

The 1440 series is finished in Brushed Nickel as a standard offering. Options include all Brownlee paint finishes.

WARRANTY

5 year limited warranty on this LED product. Consult factory for details.

PROJECT:
MODEL #:
FIXTURE TYPE:

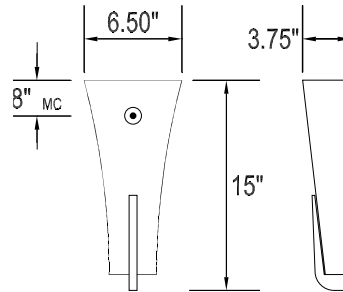

BN finish



DAMP



ORDERING INFORMATION

1440 - _____
Model 2. 3. 4. 5. (if required)

2. FINISH

STANDARD
BN Brushed Nickel

OPTIONAL
BL Black
BZ Bronze
GM Gun Metal
MB Metallic Bronze
MG Metallic Gold
NT Nickel Tone
PL Platinum
WH White

CUSTOM
Provide color sample or RAL code to match

3. WATTAGE

B06 6W B Series LED, .05 A input, 550 delivered lumens. Non-dimming.
B12 12W B Series LED, .10 A input, 1089 delivered lumens. Dimmable (0-10V).
C09 9W C Series LED, .10 A input, 768 delivered lumens. Dimmable (0-10V).

*Delivered lumens noted in 3500K

4. COLOR TEMPERATURE

35K 3500K standard color temperature
27K 2700K color temperature
30K 3000K color temperature
40K 4000K color temperature

5. AVAILABLE OPTIONS

90R⁰ 90 CRI (3000K only)
BAC¹ Buy American Compliant
DTR⁴ Triac (Line Voltage) Dimming (120V) (All except B06)
ES⁶ ENERGY STAR® (Not available in 90 CRI)
FCL⁷ French Canadian Labels
T24⁹ Title 24 JA8 Compliant (B12 in 3000K only)

Notes: (0) **90R** - cannot be combined with ES. (1) **BAC** - cannot be combined with FCL. (2) **BBI/BBS/BBC** - cannot be combined with ECW, EXT, or T24. (3) **BLD** - includes integral OCC sensor (do not combine with OCC option). Cannot be combined with DTR or T24. (4) **DTR** - cannot be combined with BLD or T24. (5) **ECW** - cannot be combined with BBI, BBC, or DTR. (6) **ES** - cannot be combined with 90R or T24. (7) **FCL** - cannot be combined with BAC or T24. (8) **OCC** - integral ON/OFF occupancy sensor. (9) **T24** - includes JA8 labeling and 90 CRI LEDs (do not combine with 90R option). Cannot be combined with BBI, BBC, BBS, BLD, DTR, ES, or FCL. (10) **BBS** - cannot be combined with BLD, ECW, EXT, OCC, or T24. (11) **PCH/PC4** - cannot be combined with BLD or OCC.
Add'l Notes: ***BBI/BBS/BBC** - standard BBI (and BBS) option has a minimum operating temperature of 10C/50F. BBC option has a minimum operating temperature of -20C/-4F. ****BLD** - integral OCC sensor with onboard control. 1: Motion is detected, illuminate to 100%. 2: Motion no longer detected, dim to 50% (factory default), 30%, 20% or 10%. 3: Remain in continuous dimmed state (factory default) or turn off after set period.

Specifications and dimensions subject to change without notice.
Consult your Brownlee Lighting representative for availability and ordering information.



REVISED
2020.12.22